



Grasmere Road, Royton

£210,000

 2  1  3



- Semi-Detached Bungalow
- Two Bedrooms
- Conservatory
- Popular & Convenient Location
- Driveway & Garage
- South Facing Rear Garden
- Three Reception Rooms
- EPC Rating - E
-
-



Ground Floor

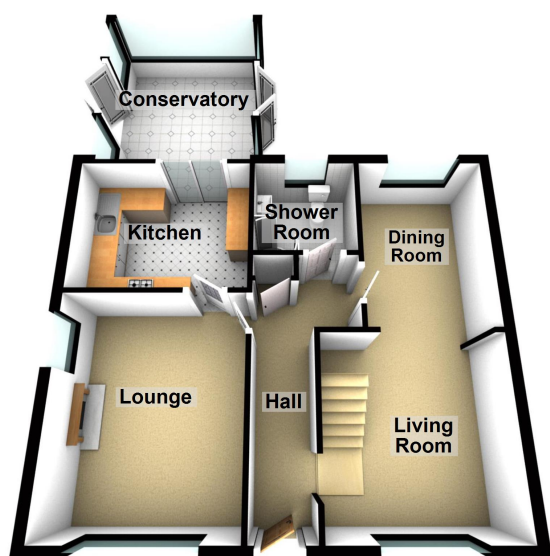

First Floor

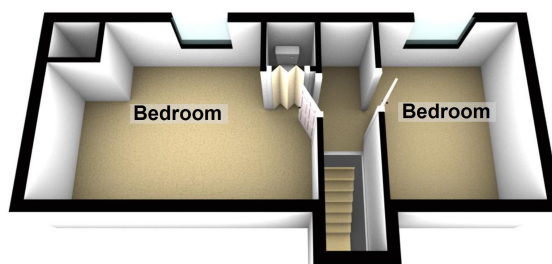

Offered for sale is this two bedroom, semi-detached property located in this sought after location in Royton. Accommodation comprising of: entrance hallway, lounge, living room, dining room, kitchen, conservatory and a bathroom to the ground floor with two bedrooms and a w.c. to the first floor. Externally a South facing rear garden, garage and driveway for up to 3/4 cars.