



Millwood Court

Royton, Oldham

£134,950

- Ground Floor Apartment
- Intercom Entry System
- No Chain
- Two Bedrooms
- Small Private Garden
- Allocated Parking
- Walking Distance To Royton Centre
- EPC Rating - D



Situated on a private road overlooking Royton Park is this two bedroom, ground floor apartment offered for sale with No Chain. Benefitting from electric heating, double glazing and an intercom entry system. The accommodation internally comprises of: entrance hallway, kitchen, lounge, shower room and two bedrooms. Externally the property has its own private garden and an allocated parking space. The property is within easy reach of public transport links, Royton centre and all associated amenities including a leisure and health centre are within a stones throw away.

ENTRANCE HALLWAY

With uPVC entrance door, shoe cabinets in the entrance porch area.

KITCHEN

11' 2" x 8' 8" (3.4m x 2.64m) With fitted wall and base units, worktops, stainless steel sink unit, splash back tiling, plumbed for an automatic washing machine, Neff oven, hob, chimney hood extractor fan, electric heater.

SHOWER ROOM

Fitted with a three piece suite in white comprising of: shower cubicle, low level w.c., wash hand basin, airing storage cupboard, electric heater, part tiled walls, tiled floor covering.

BEDROOM ONE

11' 5" x 17' 8" (3.48m x 5.38m) With uPVC double glazed window, fitted carpeting, fitted mirror wardrobes, electric storage heater.

BEDROOM TWO

6' 3" x 11' 5" (1.91m x 3.48m) With uPVC double glazed window, fitted carpeting, fitted wardrobes, electric storage heater.

LOUNGE

11' 2" x 15' 5" (3.4m x 4.7m) With uPVC double glazed French doors, electric fireplace with surround and hearth, coved ceiling, fitted carpeting, radiator.

EXTERNALLY

There is small private garden area and allocated parking.

ADDITIONAL INFORMATION

TENURE: Leasehold - Solicitor to confirm details.

COUNCIL BAND: A

VIEWING ARRANGEMENTS: Strictly by appointment with the agents.

SERVICE CHARGE: Approximately £130.00 p.c.m

AGENTS NOTE

Whilst every care has been taken to prepare these sales particulars they are for guidance purposes only. Potential buyers should fully investigate any issues that maybe personally important to them prior to completion. All measurements are approximate and are for general guidance purposes only and whilst every care has been taken to ensure their accuracy, they should not be relied upon and potential buyers are advised to recheck the measurements. Fixtures and Fittings stated as included in the property are based on achieving the asking price.



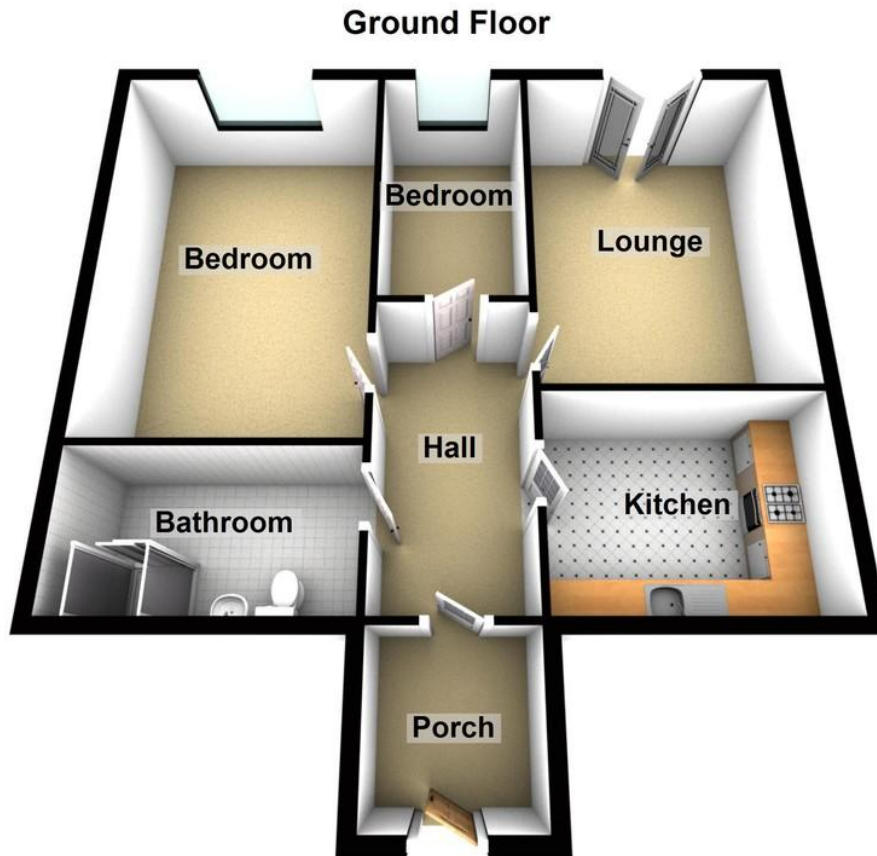

Royton Office
64 Rochdale Road
Royton
Oldham
OL2 6QJ

Monday – Friday. 9am – 5pm
Saturday. 10am – 3 pm
royton@kirkham-property.co.uk
0161 626 9789

Out of hours telephone service
Monday – Thursday 8:30am – 7pm
Friday – 8:30am – 5pm
Saturday – Sunday 10am – 3pm