



Milnrow Road, Shaw

£130,000

🛏️ 2 🪑 1 🚗 1



- No Chain
- Two Bedrooms
- Garden Fronted Mid Terraced House
- Located In The Heart of Shaw Centre
- Fitted Kitchen/Diner
- uPVC Double Glazing & Gas Central Heating
- Walking Distance To The Metro Link Station
- EPC Rating - D

No Chain. Offered for sale is this garden fronted, stone terraced property located in the heart of Shaw. Accommodation briefly comprises of: entrance vestibule, lounge and a kitchen/dining room to the ground floor and to the first floor there are two good size bedrooms and a bathroom. Externally there is a garden forecourt and on road parking. Local schools are within walking distance.

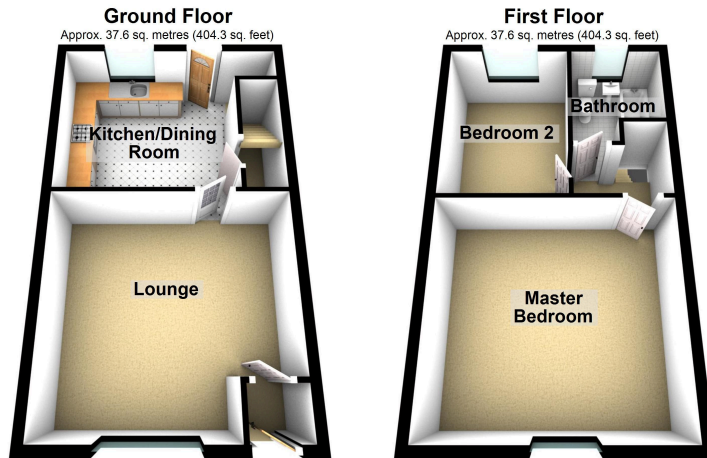

Total area: approx. 75.1 sq. metres (808.7 sq. feet)

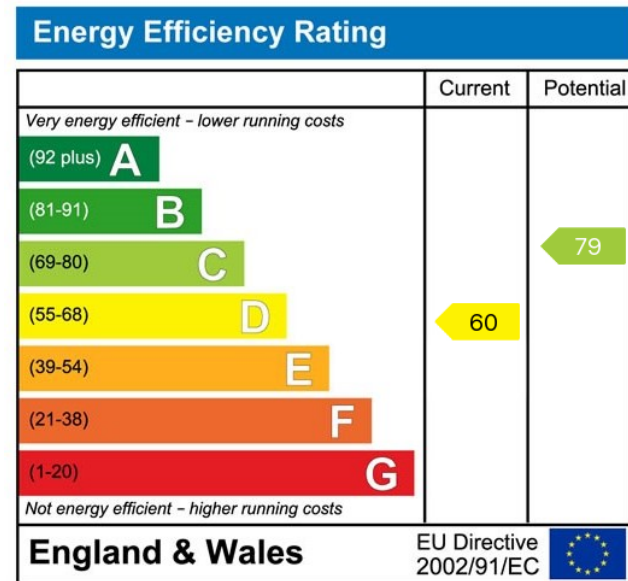

Royton Office
64 Rochdale Road,
Royton, Oldham,
OL2 6QJ

Monday – Friday. 9am – 5pm
Saturday. 10am – 3 pm
royton@kirkham-property.co.uk
t: 0161 626 9789
f: 0161 652 0514

Out of hours telephone service
Monday – Thursday 8:30am – 7pm
Friday – 8:30am – 5pm
Saturday – Sunday 10am – 3pm