



Woodbrow Mill, Denshaw, Saddleworth

£410,000

🛏 3 🍳 2 🛋 1



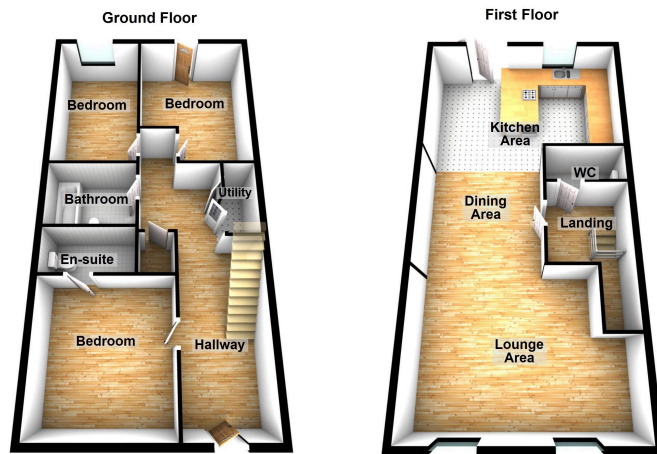

A brand new home within a former Woollen Mill! Woodbrow Mill has been sympathetically restored to create three high specification homes within an idyllic setting. Fantastic views are found to the front and rear, the history of Woodbrow Mill can be traced back over two centuries ago in the final year of King George III's reign. Open plan living is found on the first floor which includes character roof trusses throughout and maximises the far reaching views all over the surrounding landscape to the front and garden/countryside to the rear.

Uppermill Office

35 High Street
Uppermill,
Saddleworth
OL3 6HS

Monday – Friday. 9am – 5pm
Saturday. 10am – 3 pm
uppermill@kirkham-property.co.uk
t: 01457 810 076
f: 01457 810 222

Out of hours telephone service
Monday – Thursday 8:30am – 7pm
Friday – 8:30am – 5pm
Saturday – Sunday 10am – 3pm

www.kirkham-property.co.uk