



Carr Farm, Diggle, Saddleworth

£497,000

🛏️ 2 🚿 2 🛋️ 1



- Grade II Listed Georgian Weavers Cottage
- Two Large Double Bedrooms
- No Onward Chain
- Fantastic Views
- 1.4 Acres Of Grazing Land & 3 Hunter Size Stables
- Large Reception Room
- Exceptionally Presented Throughout
- Idyllic Hamlet Location Within Diggle



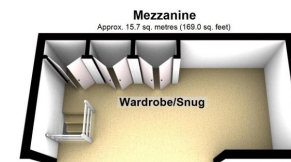
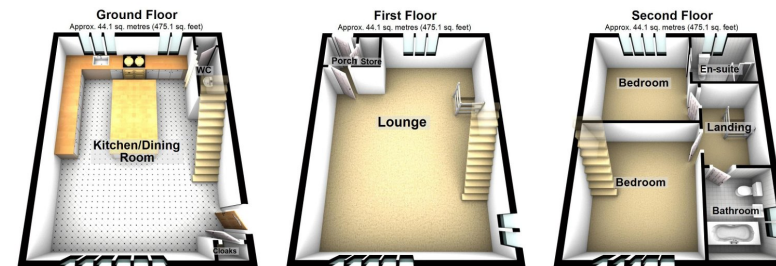

Total area: approx. 148.1 sq. metres (1594.4 sq. feet)

Presented to the market is this unique opportunity to acquire a quintessentially characterful Grade II weavers cottage, positioned within a rural hamlet location in the village of Diggle. Carr Farm oozes a fine balance of charm and contemporary style from the moment you enter and can only be truly appreciated upon internal inspection.

Uppermill Office

35 High Street
Uppermill,
Saddleworth
OL3 6HS

Monday – Friday. 9am – 5pm
Saturday. 10am – 3 pm
uppermill@kirkham-property.co.uk
t: 01457 810 076
f: 01457 810 222

Out of hours telephone service
Monday – Thursday 8:30am – 7pm
Friday – 8:30am – 5pm
Saturday – Sunday 10am – 3pm