

Fields New Road, Chadderton, Oldham, OL9 8NT

Offers Over £130,000

🛏️ 2 🚿 1 🚗 1



- Mid Terraced House
 - Enclosed Yard to Rear
 - Gas Central Heating
 - EPC rating TBC
 -
- Two Bedrooms
 - Double Glazing
 - NO CHAIN
 -
 -

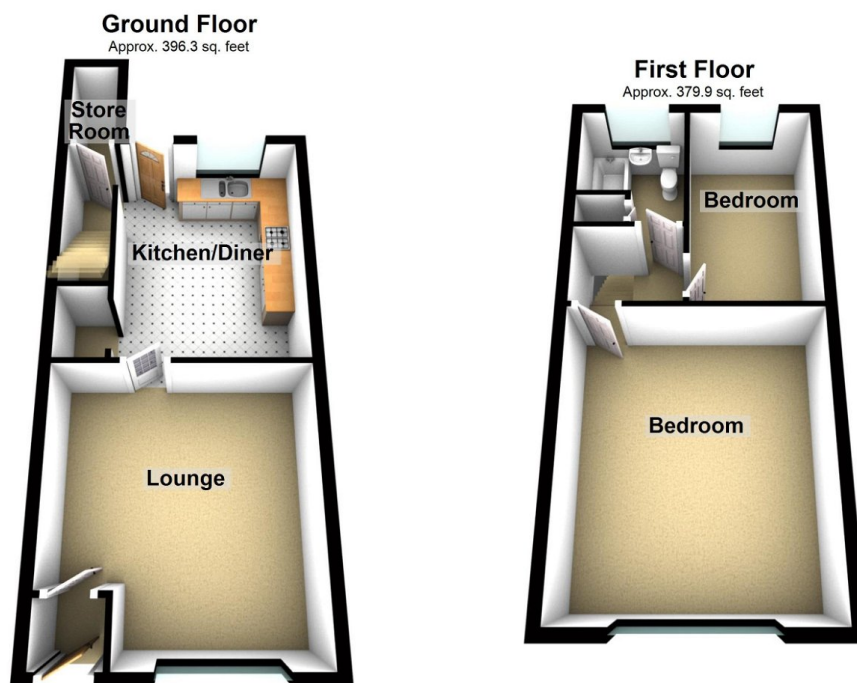

Total area: approx. 776.2 sq. feet

Ideally suited to first time buyers or young family is this two bedroom mid-terrace property located in a popular area of Chadderton close to public transport links including the Metrolink, local shops and amenities. The property briefly comprises of: entrance vestibule, lounge, dining kitchen and store room to the ground floor and to the first floor there are two bedrooms and a bathroom. Externally there is a garden forecourt and an enclosed garden to the rear. The property benefits from uPVC double glazing and gas central heating.