



Old Road, Ashton-under-Lyne

Fixed Price £275,000

🛏️ 4 🚿 1 🚗 0



- Semi-Detached Property
- NO CHAIN
- Some Updating Required
- GCH & uPVC Double Glazed
- Four Bedrooms
- Flexible Accommodation
- Countryside Views to Rear
- EPC Rating - D

With NO CHAIN this four bedroom, extended Semi-Detached family property ideally located in a much sought after area of Ashton-under-Lyne, with open aspect countryside views to the rear whilst also being in close proximity to all local amenities including schools and transportation links.

Within walking distance to Ashton-under-Lyne Golf Club, Hartshead Pike and the Pennine bridal path.

Generously proportioned throughout, offering versatile family living with potential to reconfigure accommodation to suit.

Internally the property's current layout consists of:- Entrance Porch, Hallway, Lounge through to Dining Area, Kitchen, Four Spacious Bedrooms and Bathroom.

With GCH & Double Glazing throughout.

Exi
an
pa

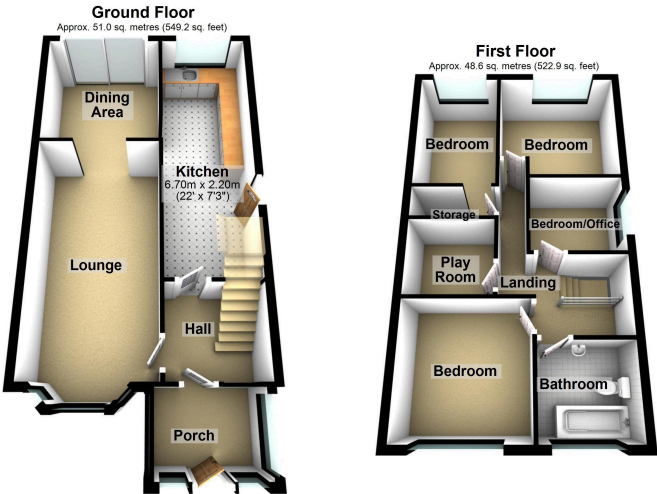

Total area: approx. 99.6 sq. metres (1072.1 sq. feet)

ay
j



Score	Energy rating	Current	Potential
92+	A		
81-91	B		
69-80	C		79 C
55-68	D	65 D	
39-54	E		
21-38	F		
1-20	G		

Chadderton Office
509 Middleton Road,
Chadderton, Oldham,
OL9 9SH

Monday – Friday. 9am – 5pm
Saturday. 10am – 3 pm
chadderton@kirkham-property.co.uk
t: 0161 626 5688
f: 0161 628 0350

Out of hours telephone service
Monday – Thursday 8:30am – 7pm
Friday – 8:30am – 5pm
Saturday – Sunday 10am – 3pm