



Westdown Gardens, Shaw

£430,000

🛏️ 4 🚿 2 🛋️ 3



- Executive family Home
- Two Reception Rooms
- South Facing Rear Garden
- Large Detached Garage
- Four Bedrooms, Master En Suite
- Large Spacious Conservatory
- Excellent Condition Throughout
- EPC:C

Kirkham Property are very happy to be able to bring this stunning executive four bedroom detached family home located in this popular select cul de sac of only six properties in High Crompton which rarely ever come to market. Offering superb accommodation comprising: Entrance porch, hallway, lounge, dining room, kitchen, utility room, cloakroom/WC and a large conservatory. To the first floor are four bedrooms (master en suite) and a lovely bathroom. Local schools within a short walk. Shaw town centre and the local tram stop within a 10-15 walk. This outstanding home is presented in wonderful condition and viewing is highly recommended, so call us today to arrange one.

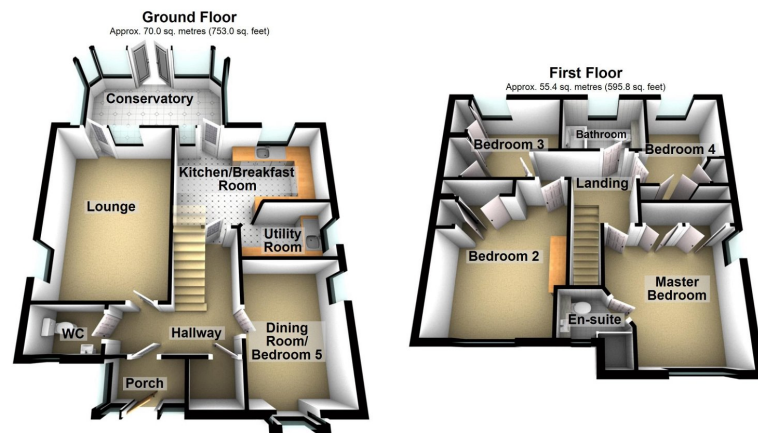

Total area: approx. 125.3 sq. metres (1348.8 sq. feet)

Score	Energy rating	Current	Potential
92+	A		
81-91	B		83 B
69-80	C	74 C	
55-68	D		
39-54	E		
21-38	F		
1-20	G		

Chadderton Office
 509 Middleton Road,
 Chadderton, Oldham,
 OL9 9SH

Monday – Friday. 9am – 5pm
 Saturday. 10am – 3 pm
 chadderton@kirkham-property.co.uk
 t: 0161 626 5688
 f: 0161 628 0350

Out of hours telephone service
 Monday – Thursday 8:30am – 7pm
 Friday – 8:30am – 5pm
 Saturday – Sunday 10am – 3pm