





# Manor Close, Grasscroft, Saddleworth

£635,000

🛏 4 🚿 2 🛋 2





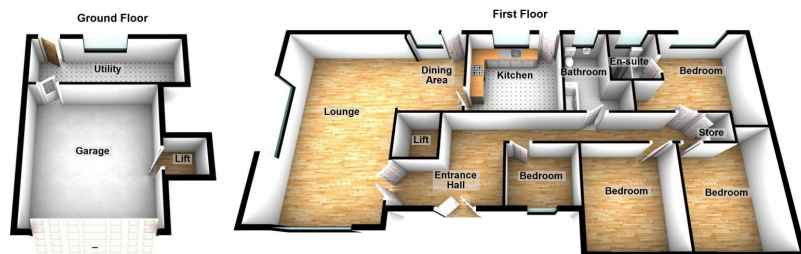

Situated on a quiet Cul-De-Sac with fantastic far reaching views, this detached four bedroom home is being sold with no onward chain and has a good sized rear garden. Manor Close features only five properties and this home is elevated which captures great views from the lounge.

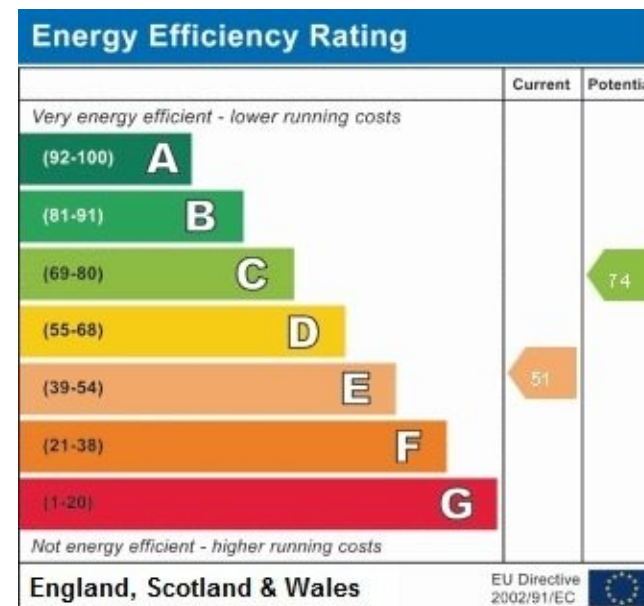

### Uppermill Office

35 High Street  
Uppermill,  
Saddleworth  
OL3 6HS

Monday – Friday. 9am – 5pm  
Saturday. 10am – 3 pm  
uppermill@kirkham-property.co.uk  
t: 01457 810 076  
f: 01457 810 222

Out of hours telephone service  
Monday – Thursday 8:30am – 7pm  
Friday – 8:30am – 5pm  
Saturday – Sunday 10am – 3pm

[www.kirkham-property.co.uk](http://www.kirkham-property.co.uk)