



Park View, Currier Lane, Ashton-under-Lyne, OL6 6TB

£699,950



ALL. TOGETHER. BETTER.

www.kirkham-property.co.uk

Park View, Currier Lane, Ashton-under-Lyne, OL6 6TB

This unique four bedroom Victorian detached villa is superbly positioned within its own extensive grounds, set back from the historic Currier Lane in one of Ashton-under-Lyne's much sought after locations.

The resplendent family accommodation provides a unique opportunity to purchase not only a splendid Victorian detached property but a life style and way of living seldom obtainable.

Within the property's grounds lies a capacious lawn as well as a stable block including a triple garage (with electric doors) along with ample parking.

Set over four floors the property's stately accommodation briefly comprises:-

Large Basement

To the Ground Floor: Entrance Hall, Three Receptions, Kitchen/Diner, Utility & Shower room.

To the First Floor: Four Bedrooms (one with en-suite) & Family Bathroom.

Attic: With Three Rooms.

With full Gas Central Heating and uPVC double glazed windows throughout.





This unique four bedroom Victorian detached villa is superbly positioned within its own extensive grounds, set back from the historic Currier Lane in one of Ashton-under-Lyne's much sought after locations.

The resplendent family accommodation provides a unique opportunity to purchase not only a splendid Victorian detached property but a life style and way of living seldom obtainable.

Within the property's grounds lies a capacious lawn as well as a stable block including a triple garage (with electric doors) along with ample parking.

Set over four floors the property's stately accommodation briefly comprises:-

Large Basement

To the Ground Floor: Entrance Hall, Three Receptions, Kitchen/Diner, Utility & Shower room.

To the First Floor: Four Bedrooms (one with en-suite) & Family Bathroom.

Attic: With Three Rooms.

With full Gas Central Heating and uPVC double glazed windows throughout.







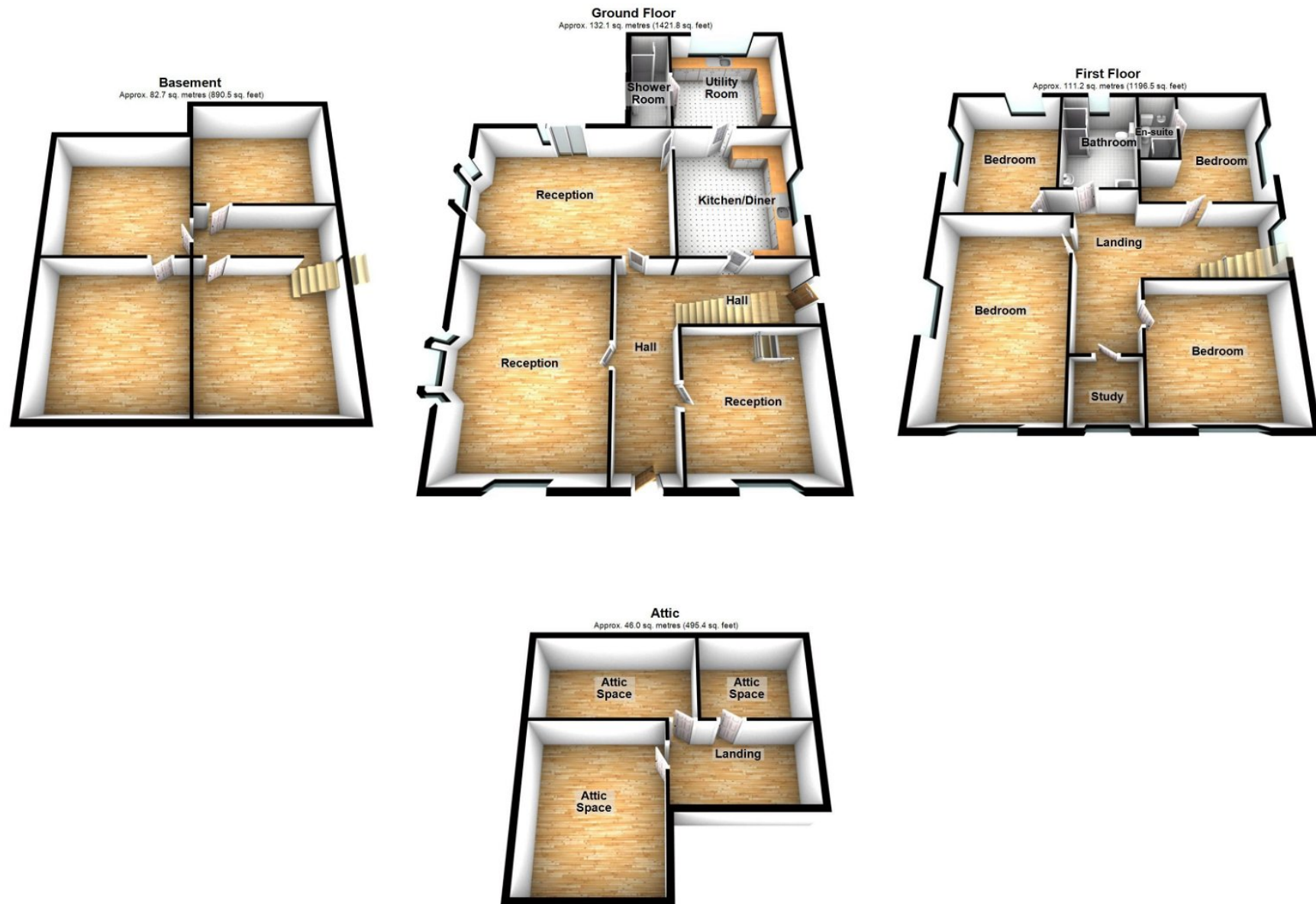

Total area: approx. 372.0 sq. metres (4004.2 sq. feet)

Chadderton Office

509 Middleton Road,
Chadderton, Oldham,
OL9 9SH

Monday – Friday. 9am – 5pm
Saturday. 10am – 3 pm
chadderton@kirkham-property.co.uk
t: 0161 626 5688
f: 0161 628 0350

Out of hours telephone service
Monday – Thursday 8:30am – 7pm
Friday – 8:30am – 5pm
Saturday – Sunday 10am – 3pm