



Spring Mill Drive, Mossley

£350,000

🛏 4 🚿 2 🛋 2



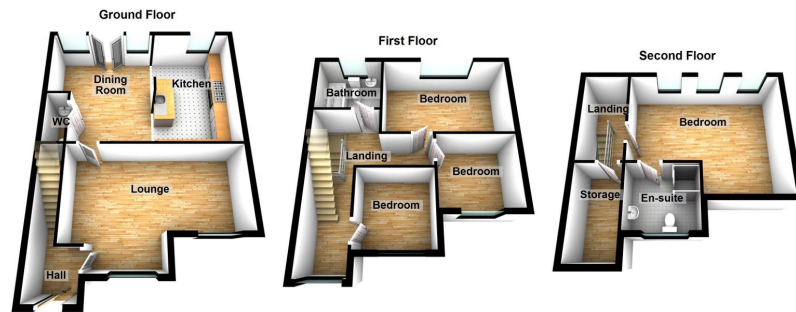

This large four bedroom end townhouse is the former show-home for the development and provides everything needed for modern family living. Situated towards the front of the development for ease of access and with a South facing enclosed rear garden to the rear which catches the sun all day this modern property is certainly worth a look.

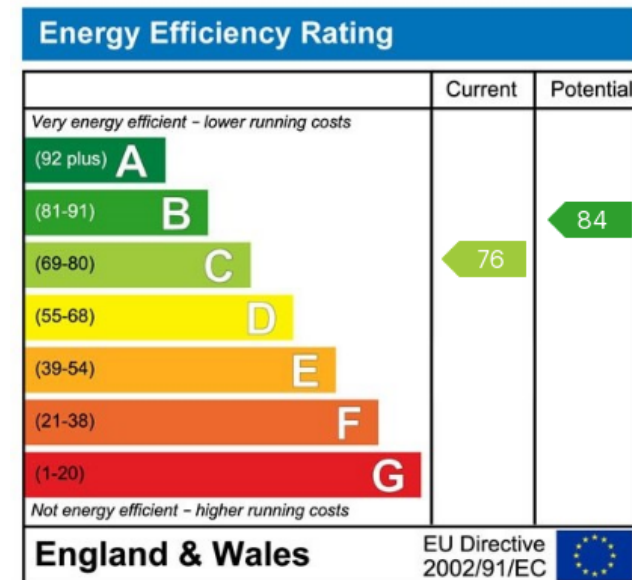

Uppermill Office

35 High Street
Uppermill,
Saddleworth
OL3 6HS

Monday – Friday. 9am – 5pm
Saturday. 10am – 3 pm
uppermill@kirkham-property.co.uk
t: 01457 810 076
f: 01457 810 222

Out of hours telephone service
Monday – Thursday 8:30am – 7pm
Friday – 8:30am – 5pm
Saturday – Sunday 10am – 3pm

www.kirkham-property.co.uk