

ALL. TOGETHER. BETTER.

[www.kirkham-property.co.uk](http://www.kirkham-property.co.uk)

## 744 Ripponden Road, Oldham

£289,950

🛏 4 🍷 2 🛋 2



- Stone Built Semi Detached
- Set Over Three Floors
- Lovely Side Garden
- Amazing Condition
- 
- Four Bedrooms & En Suite
- Open Plan Living
- Stones Throw From Saddleworth
- EPC:
- 

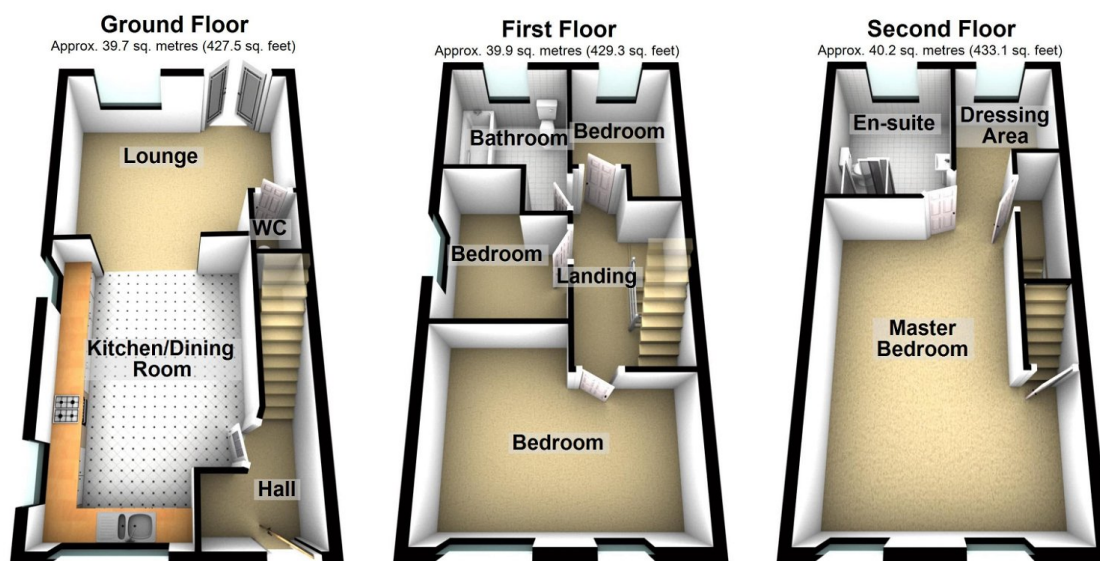

Total area: approx. 119.8 sq. metres (1289.9 sq. feet)

**NO CHAIN.** Offered for sale is this gorgeous stone built four bedroom semi detached family home located within a stones throw of Saddleworth. Accommodation comprising: Entrance hallway, open plan kitchen/dining room, lounge and a cloakroom/WC. To the first floor are three bedrooms and a bathroom. To the second floor is a master suite that offers superb searching views, dressing area and a large En-suite shower room. Externally a private rear garden and gated allocated parking for two cars. Call us today to arrange an appointment.