



Huddersfield Road, Diggle, Saddleworth

£215,000

3 1 1



- Stone Terrace Property
- Three Bedrooms
- Communal Rear Yard
- Central Village Location
- Gas central heated & double glazed
- Primary & Secondary School Nearby
- Ideal First Purchase
- Energy Rating C



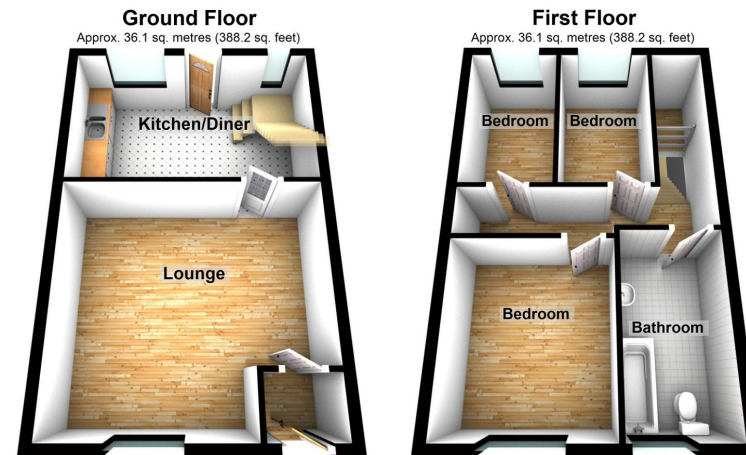

Total area: approx. 72.1 sq. metres (776.3 sq. feet)

Located in central Diggle village is this stone terrace property. Well presented to the market and making the ideal first home in one of Saddleworth's most popular villages, this home is within easy walking distance of both Diggle Primary School and Saddleworth Secondary School.

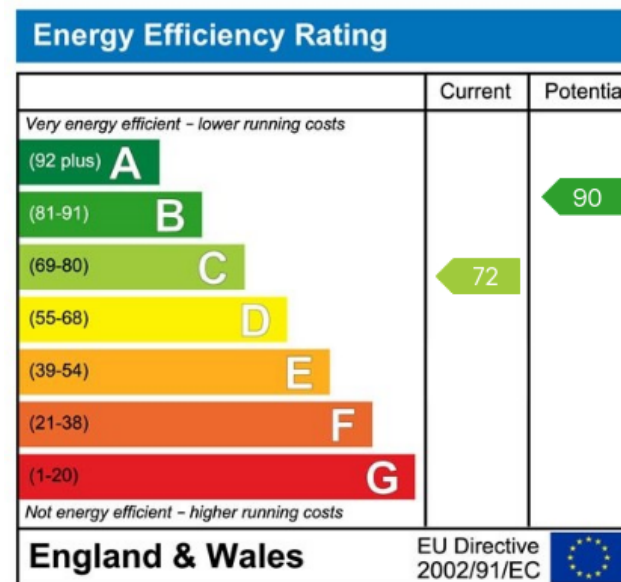

Uppermill Office

35 High Street
Uppermill,
Saddleworth
OL3 6HS

Monday – Friday. 9am – 5pm
Saturday. 10am – 3 pm
uppermill@kirkham-property.co.uk
t: 01457 810 076
f: 01457 810 222

Out of hours telephone service
Monday – Thursday 8:30am – 7pm
Friday – 8:30am – 5pm
Saturday – Sunday 10am – 3pm