



Huddersfield Road, Lees, Oldham

£288,000

3 1 2



- Spacious Middle Terrace
- Large Gardens To Front & Rear
- Exceptionally Presented Throughout
- Close Proximity To Saddleworth Villages
- Three Bedrooms Plus Loft Room
- Period Features Throughout
- Off Street Parking To The Rear
- Energy Rating D



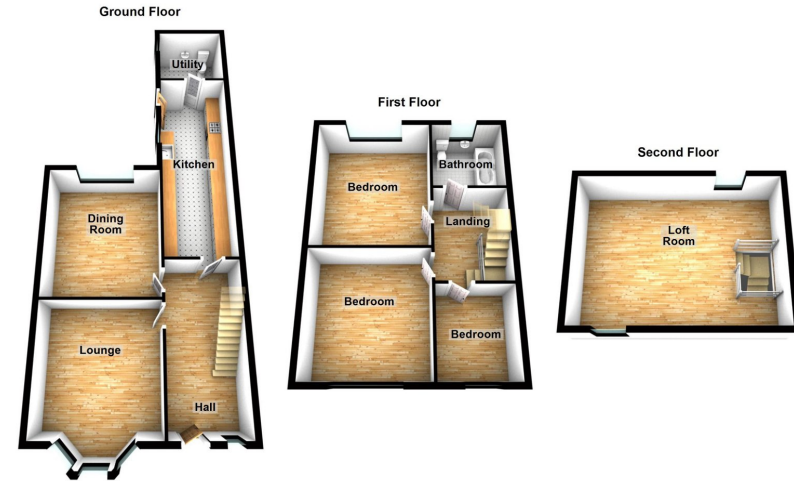

Presented to the market is this very spacious middle terrace property which has been continuously updated by the current owners to create a period yet contemporary feel throughout. A standout feature of the home is the kitchen where no expense has been spared, creating a bright cooking space with high quality units and quartz worktops. Further enhancements have been added including an overhaul of the heating system, new double glazing to the rear and secure composite entrance door to the front.

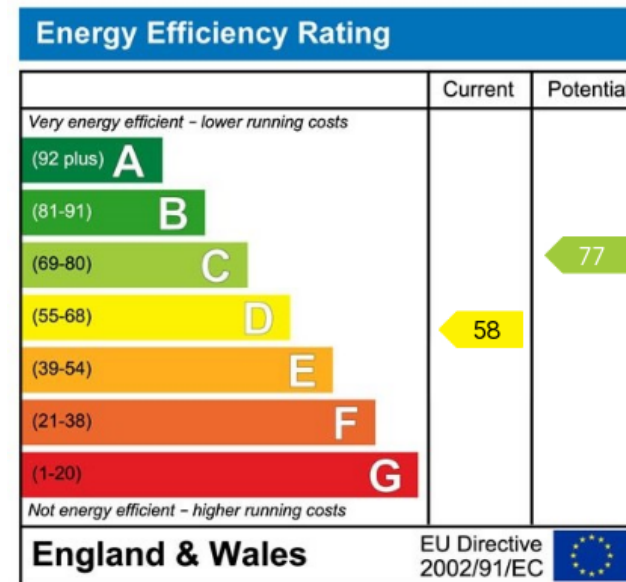

Uppermill Office

35 High Street
Uppermill,
Saddleworth
OL3 6HS

Monday – Friday. 9am – 5pm
Saturday. 10am – 3 pm
uppermill@kirkham-property.co.uk
t: 01457 810 076
f: 01457 810 222

Out of hours telephone service
Monday – Thursday 8:30am – 7pm
Friday – 8:30am – 5pm
Saturday – Sunday 10am – 3pm