



Mount View, Uppermill, Saddleworth

£280,000

3 1 1



- Stone Built Mid Terrace
- Off Road Parking
- Front Garden With Pleasing Outlook
- Set Over Three Floors
- Three Bedrooms
- Short Walk To Uppermill Village
- Raised Back Garden With Sunny Aspect
- Energy Rating E





Located in the heart of Uppermill is this three bedroom Victorian stone terrace. Mount View's very popular location provides an abundance of local amenities and is just a minuets walk away from the Huddersfield Narrow Canal which offers stunning walks to nearby villages. Regular rail routes to Manchester and Huddersfield can also be easily accessed from Greenfield Rail Station which is only a fifteen minuet walk away.

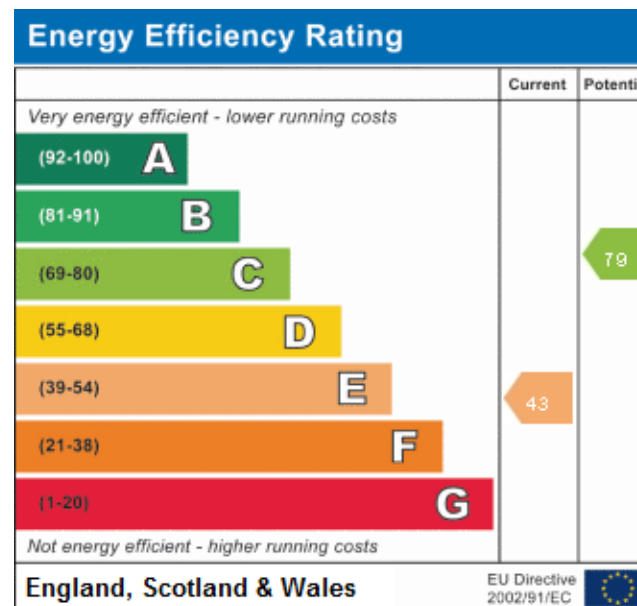
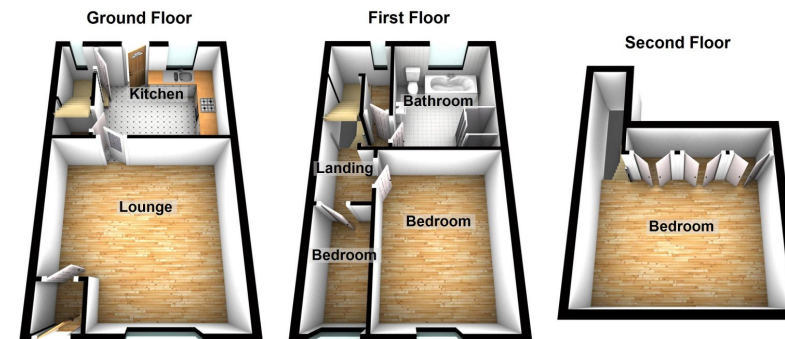

Uppermill Office

35 High Street
Uppermill,
Saddleworth
OL3 6HS

Monday – Friday. 9am – 5pm
Saturday. 10am – 3 pm
uppermill@kirkham-property.co.uk
t: 01457 810 076
f: 01457 810 222

Out of hours telephone service
Monday – Thursday 8:30am – 7pm
Friday – 8:30am – 5pm
Saturday – Sunday 10am – 3pm