



12 The Park, Greenfield

£425,000

🛏 4 🚿 1 🛋 2



- Semi Detached
- Two Reception Rooms
- Stunning Views
- EPC - D
- Four Bedrooms
- Superb Family Home
- Popular Location



Situated in an enviable location with truly stunning views is this four bedroom two reception room semi detached property. Providing a superb family home the property sits in an elevated position on a quiet Cul-de-sac close to local amenities, excellent transport links and delightful countryside walks. Beautifully presented throughout the spacious living accommodation comprises porch, hallway, lounge with large bay window affording amazing views, kitchen with many integrated appliances and a separate sitting/dining room. Off the first floor landing there are four bedrooms (three doubles and a single) and a modern family bathroom. Externally there are mature well kept gardens to both the front and rear and to the side a driveway providing off road parking leading to a detached single garage. The property also benefits from GCH and double glazing. Viewing comes recommended to appreciate this great family home.

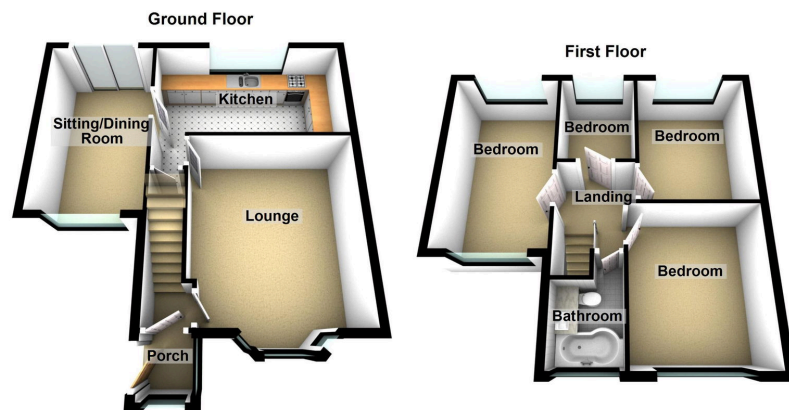

Energy Efficiency Rating		
	Current	Potential
Very energy efficient – lower running costs		
(92 plus) A		
(81-91) B		85
(69-80) C		
(55-68) D	61	
(39-54) E		
(21-38) F		
(1-20) G		
Not energy efficient – higher running costs		
England & Wales	EU Directive 2002/91/EC	

Chadderton Office

509 Middleton Road,
Chadderton, Oldham,
OL9 9SH

chadderton@kirkham-property.co.uk
t: 0161 626 5688